

The Stephanie Country Mansion Dollhouse
Assembly Instruction
By Laser Dollhouse Designs



Note : Highly recommend dry assembly (NO GLUE) prior to actual assembly to familiarize with parts and locations.

Parts for assembly



Base floor marked S1 thru S11



First floor marked 1A thru 1K



Second floor marked 2A thru 2K



Third floor marked 3A thru 3D



(5) Interior and (2) main assembled doors



4 large window frames



20 small window frames

Parts for assembly Continued



Porch roof assembly



Plexiglas inserts



**Window
Shutters (24)**



**Porch stair
assembly**



**Stair assemblies and
rails**

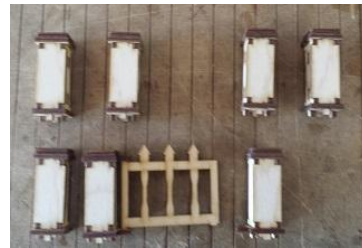

**Fence post and
operating
picket fence**



Balcony rails



Interior door frames



Fence rails (6)



**Dormer
assembly**

Parts for assembly Continued



Front main and rear
main roof



Front roof



First floor walls marked 1A thru 1K



3rd Floor walls marked 3A
thru 3D



Octagon window
frames



Second floor walls marked 2A thru 2K (There is **NO** 2B)



Roof running rail



Base support parts marked S1 thru S11

Step 1. locate the Base marked S1 thru S11 and support rails marked S1 thru S11 (note (3) S11 parts) and insert marked tabs into matching slots. See figure 1



Figure 1

Step 2. Take floor 1 marked 1A thru 1K and install on top of completed base floor , see figure 2



Figure 2

Step 3. If this is not a dry assembly then complete this step. Install all interior doors and door frames, see figure 3.

Note: Interior door on Walls 1G and 2G are to open to the Room NOT hallway to avoid stairs.



Figure 3

Step 4. If this is not a dry assembly then complete this step. Install main entrance and balcony access door and interior frames, see figure 4



Figure 4

Step 5. If this is not a dry assembly then complete this step, Install window frames to all walls then take Plexiglas and install into cutout openings in walls, match interior window frames by aligning with exterior frames, see figure 5.



Figure 5

Step 6. Install first floor walls and sun room walls marked 1A thru 1K, see figure 6.



Figure 6

Step 7. Install assembled stairs from the bottom up thru the cutout in second floor , see figure 7.

Step 8. Install second floor to top of first floor walls matching carefully the cutout slot to first floor wall tabs, See figure 8.



Figure 7



Figure 8

Step 9. Install stair rails to second floor, See figure 9.



Figure 9

Step 10. Install second floor walls and porch rails marked 2A thru 2K, See figure 10.



Figure 10

Step 11. Install porch roof assembly, see figure 11



Figure 11

Step 12. Install assembled stairs from the bottom up thru the cutout in third floor, see figure 12.

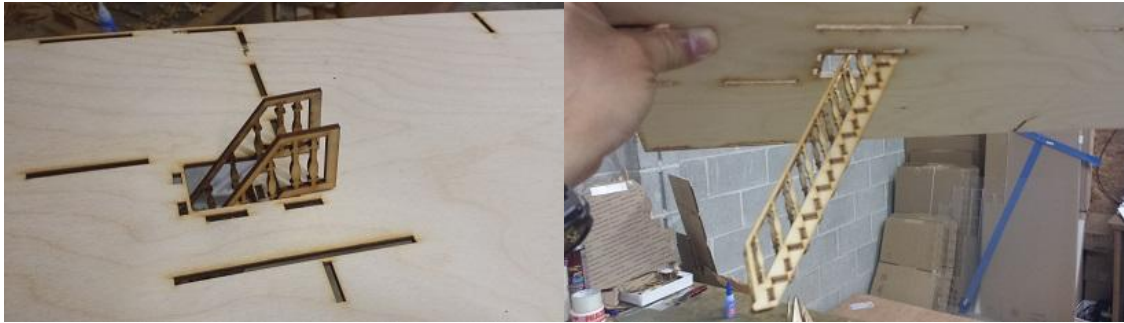

Figure12

Step 13. Install third floor onto 2nd floor walls, see figure 13



Figure13

Step 14. Install 3rd floor stair rails, see figure 14



Figure14

Step 15. Install 3rd floor walls 3B, 3C and 3D, see figure 15.



Figure15

Step 16. Install rear main roof panel to 3B, 3C and 3D, see figure 16.



Figure16

Step 17. running roof trim to top of 3B, 3C and 3D, see figure 17.



Figure 17

Step 18. Install Front roof panel , see figure 18



Figure 18

Step 19. Install 3rd floor wall 3A, see figure 19



Figure 19

Step 20. Install front roof panel onto wall 3A, see figure 20



Figure 20

Step 21. Assemble dormer as you see in figure 21.



Figure21

Step 22. Install dormer to front roof panel, see figure 22.



Figure22

Step 23. install front entrance steps as seen in figure 23



Figure23

Step 24. locate small picket side fence "should not have a label and install, see figure 24

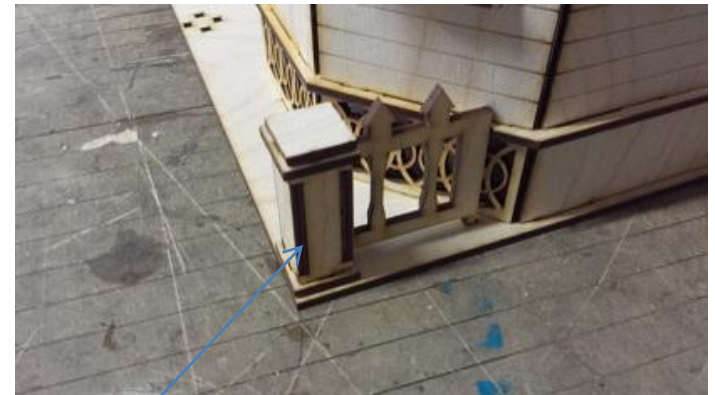

Figure24

Note: there are no holes on outer side and front of post 1

Step 25. Install fence part labeled (RF) which stands for Right Front, see figure 25



Figure25

Note: Front and back of post 2 has no holes. There are holes on each side to attach fence RF and RM.

Step 26. Install fence part labeled (RM) which stands for Right Middle, see figure 26



Figure26

Note: Front and back of post 2 has no holes. There are holes on the right side only and it has a open buckle at the left base of the post to lock the operating fence.

Step 27. Install functioning fence, see figure 27



Figure27

Step 28. Install post with holes on left and right side and fence Left Middle labeled LM, see figure 28



Figure28

Step 29. Install post with holes on right side and holes on back and install fence Left Front (LF), see figure 29



Figure29

Step 30. Install final post with only one set of holes and attach fence Left Side (LS), see figure 30
Fence is completed.



Figure30



Figure31

Step 31. Install all window shutters. See figure 31

Step 32. Install dormer frame. See figure 32



Figure32

The Stephanie Country Mansion Dollhouse is now complete!!!



Laser Dollhouse Designs

www.laserdollhouses.com

Email: laserdollhouses@aol.com